



West End Villas, DL15 9PJ  
2 Bed - House - End Terrace  
£95,000

**ROBINSONS**  
SALES • LETTINGS • AUCTIONS • SURVEYS

## West End Villas , DL15 9PJ

Robinsons are delighted to present this well-maintained two-bedroom end-terrace house to the sales market. The property benefits from gardens to the front, side, and rear, along with a pleasant open outlook. It is warmed by gas central heating and features UPVC double-glazed windows throughout.

The internal accommodation comprises an entrance vestibule, a lounge, and a kitchen fitted with a range of wall, base, and drawer units, with space provided for appliances. To the first floor there are two well-proportioned bedrooms and a family bathroom.

Outside, the enclosed gardens are mainly laid to lawn and include a paved patio area.

West End Villas is ideally located within close proximity to Crook town centre, local schooling, and bus links.

For further information or to arrange an internal viewing, please contact Robinsons.









### Agent Notes

Council Tax: Durham County Council, Band A £1748

Tenure: Freehold

Property Construction – Standard,

Number & Types of Rooms – Please refer to the details and floorplan, all measurements are for guidance only

Gas Supply - Mains

Electricity supply – Mains

Water Supply – Mains (not metered)

Sewerage – Mains

Heating – Gas Central Heating

EPC - C Rating

Estimated Mobile phone coverage – Please refer to the Ofcom Website - <https://www.ofcom.org.uk>

Estimated Broadband Download speeds – please refer to the Ofcom Website – <https://www.ofcom.org.uk>

Building Safety – The Vendor is not aware of any Building Safety issues. However, we would recommend that the purchaser engages the services of a chartered surveyor to confirm.

Restrictions – covenants which affect the property are within the Land Registry Title Register which is available for inspection.

Selective licencing area – no

Probate – being applied for N/a

Rights & Easements – None known, check with seller

Flood risk – refer to the Gov website - <https://www.gov.uk/check-long-term-flood-risk>

Coastal Erosion – refer to the Gov website - <https://www.gov.uk/check-coastal-erosion-management-in-your-area>

Protected Trees – check with seller

Planning Permission – Nothing in the local area to affect this property that we are aware of. Check with seller.

Accessibility/Adaptations – any alterations or conversions etc.

Mining Area – Coal Mining Reporting Area, further searches may be required by your legal representative.

Disclaimer: Our details have been compiled in good faith using publicly available sources and information obtained from the vendor prior to marketing. Verification and clarification of this information, along with any further details concerning Material Information parts A, B & C, should be sought from a legal representative or appropriate authorities before making any financial commitments. Robinsons cannot accept liability for any information provided subsequent amendments or unintentional errors or omissions.

HMRC Compliance requires all estate agents to carry out identity checks on their customers, including buyers once their offer has been accepted. These checks must be completed for each purchaser who will become a legal owner of the property. An administration fee of £30 (inc. VAT) per individual purchaser applies for carrying out these checks.

# West End Villas Crook

Approximate Gross Internal Area

763 sq ft - 71 sq m

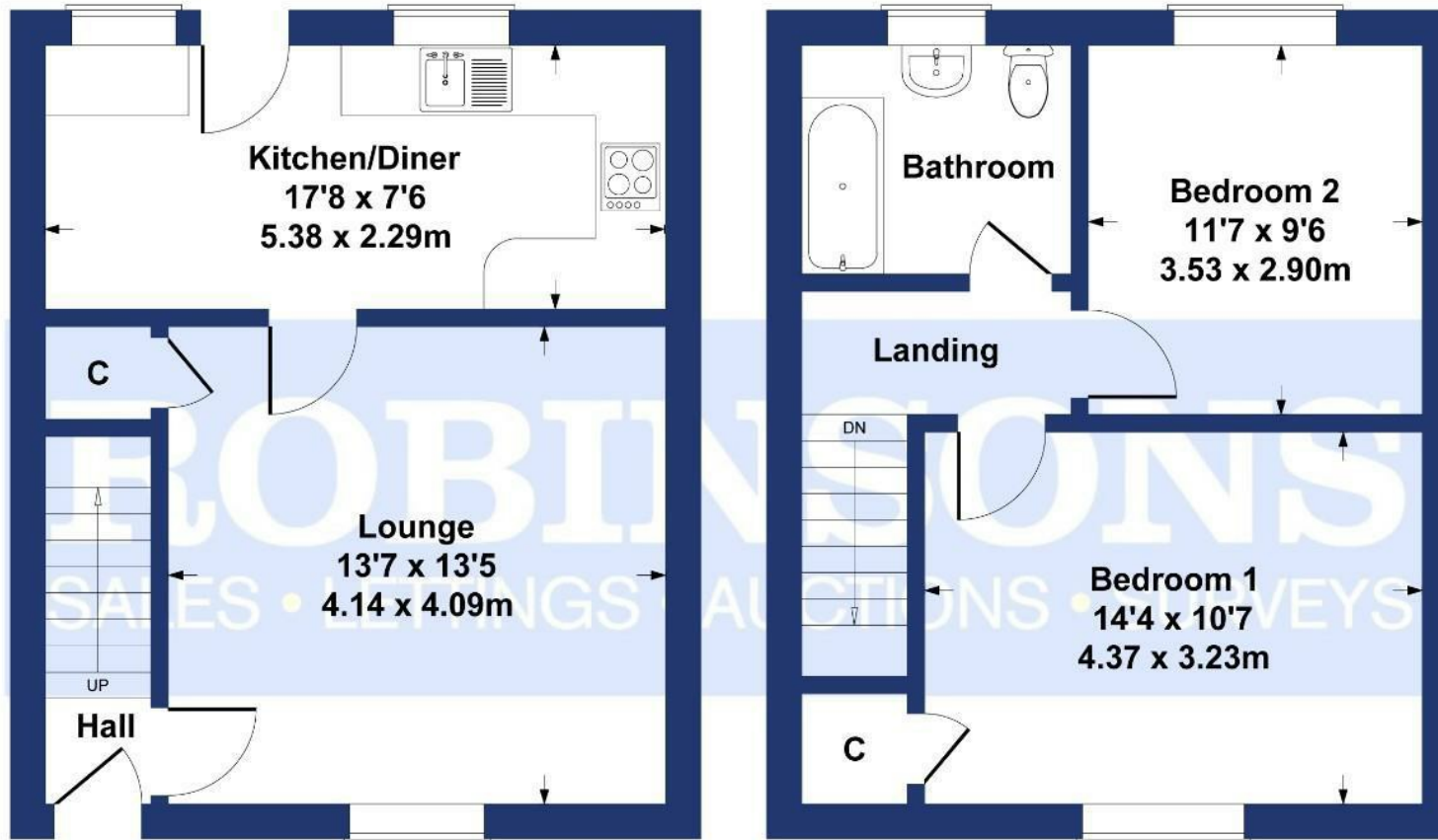

**GROUND FLOOR**

**FIRST FLOOR**

## SKETCH PLAN FOR ILLUSTRATIVE PURPOSES ONLY

All measurements walls, doors, windows, fittings and appliances, their sizes and locations, are approximate only. They cannot be regarded as being a representation by the seller, nor their agent.

Produced by Potterplans Ltd. 2025

Energy Efficiency Rating		Current	Potential
Very energy efficient - lower running costs			
(82 plus)	A		
(61-81)	B		
(49-60)	C		
(35-48)	D		
(23-34)	E		
(15-22)	F		
(1-14)	G		
Not energy efficient - higher running costs			
England & Wales		EU Directive 2002/91/EC	
		71	85

For clarification we wish to inform prospective purchasers that we have prepared these sales particulars as a general guide. We have not carried out a detailed survey, nor tested the services, appliances and specific fittings. Room sizes should not be relied upon for carpets and furnishings, if there are important matters which are likely to affect your decision to buy, please contact us before viewing the property. Robinsons can recommend financial services, surveying and conveyancing services to sellers and buyers. Robinsons staff may benefit from referral incentives relating to these services.



Royal Corner, Crook, County Durham, DL15 9UA  
Tel: 01388763477  
info@robinsonscrook.co.uk  
www.robinsonsestateagents.co.uk

